

ThinkStation P920 Rack

PERFORMANCE & SCALABILITY

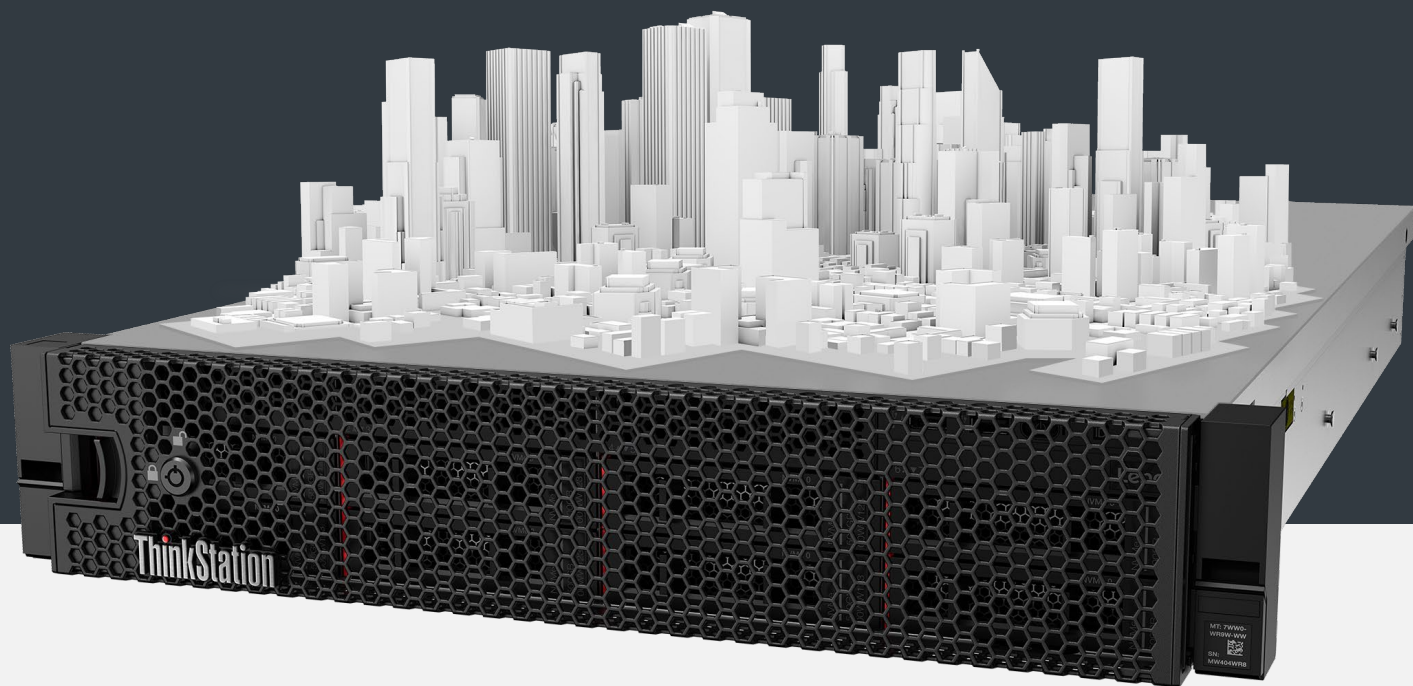

SECURITY & EFFICIENCY WITHOUT LIMITS

The ThinkStation® P920 Rack combines true professional workstation performance in a fully scalable and secure 2U form factor.

Delivering comprehensive end-to-end IT management and security, the P920 Rack allows companies to keep complex project data and company IP closer to their storage systems—inside the data center. By leveraging low-latency remote access technologies, users can seamlessly collaborate on their most critical projects, enabling ultimate mobility and enhanced workforce productivity.

Featuring hot swappable and redundant cooling fans, storage drives, and power supplies for maximum system uptime, the P920 Rack provides the legendary ThinkStation reliability your company can depend on.

FEATURES



Intel® Xeon® 2nd Gen scalable processors



Powerful NVIDIA® Quadro RTX™ graphics card



Up to 112TB of Enterprise storage



Up to 3TB of ECC memory



Hot Swap & Redundant features



Full remote management

Lenovo™

Lenovo™ ThinkStation® P920 Rack Specifications

PERFORMANCE

Processor

Dual Intel® Xeon® Scalable Processors
(up to 28 Cores, up to 4.0GHz per CPU)

Chipset

Intel C624

Operating System

Microsoft Windows Server®

Red Hat® Enterprise Linux® (certified)

SUSE® Linux Enterprise Server
(certified)

VMware® vSphere (ESXi)

Graphics

Up to 2x NVIDIA® Quadro RTX™ 6000

Up to 2x NVIDIA Tesla® V100

Up to 4x NVIDIA Tesla T4 GPUs

Total Memory

Up to 3TB DDR4, 2933MHz

24 RDIMM/3DS RDIMM Slots

Memory DIMM Capacity

8GB / 16GB / 32GB / 64GB / 128GB

Total Storage

Up to 10 Storage Drives

Max M.2 SATA = 2 (Boot Drives)

Max 3.5" = 8 (112TB)

Storage Type Capacity

3.5" SATA HDD 7200rpm up to 14TB²

M.2 SATA SSD up to 480GB²

NVMe SSD AIC up to 6.4TB²

RAID

0/1/5/10/50

CONNECTIVITY

Front Ports

(1) VGA¹

(1) USB 3.0*

(1) USB 2.0* Management

Rear Ports

(1) VGA

(2) USB 3.0*

(1) RJ-45 Management Port

(1) 2 or 4-port Ethernet (LOM)

Ethernet

2 or 4 port Integrated LAN

1GbE (Base-T)

10GbE (Base-T or SFP+)

System Management

Lenovo XClarity Remote Management

Supports Other Third Party Tools

Light Path Diagnostic LEDs

Front Access Diagnostics via

Dedicated USB Port

Expansion Slots

(3) PCIe x16

(1) PCIe x8

(1) PCIe x8 Low Profile

Security

Trusted Platform Module (TPM) 1.2/2.0

Lockable Security Bezel

Power Supply

1+1 Redundant Hot Swap

1100W (230V/115V) Platinum Efficient

1600W (230V) Platinum Efficient

DESIGN

Features

Hot Swap & Redundant Storage Drives

Hot Swap & Redundant Cooling Fans

Hot Swap & Redundant Power Supplies

113°F (45°C) Continuous Operation

Dimensions (WxDxH)

(mm): 445 x 720 x 87

(inches): 17.5 x 28.3 x 3.4

Weight

Min Configuration: 41.9lbs (19kg)

Max Configuration: 70.5lbs (32kg)

GREEN CERTIFICATIONS

ENERGY STAR®

RoHS Compliant

For a full list of accessories and options, please visit:
<https://dsc.lenovo.com/#/>

¹ Optional
² Per drive

* The actual transfer speed of the USB 3.0 will vary and, depending on many factors, such as the processing capability of host and peripheral devices, file attributes and other factors related to system configuration and your operating environments, will be slower than a speed of 5Gbit/s.

Lenovo™

RECOMMENDED SERVICES

Lenovo offers a comprehensive portfolio of services to support and protect your ThinkStation investment—so you can focus on your business, not your IT.

Premier Technical Support

Makes your priority, our priority. 24x7 priority call routing to advanced-level technicians, electronic incident tracking, and rapid response and resolution.

Warranty—Onsite and Next Business Day

Maximizes workstation uptime and productivity by providing convenient, fast repair service the next business day.

Warranty Extensions (1 to 5 years total duration)

This fixed-term, fixed-cost service helps you accurately budget for workstation expenses, protect your valuable investment, and potentially lower the cost of ownership over time.

©2020 Lenovo. All rights reserved. These products are available while supplies last. For any questions concerning price, please contact your Lenovo Account Executive. Lenovo is not responsible for photographic or typographic errors. Warranty: For a copy of applicable warranties, write to: Warranty Information, 500 Park Offices Drive, RTP, NC 27709, Attn: Dept. ZPYA/B600. Lenovo makes no representation or warranty regarding third-party products or services. Trademarks: Lenovo, the Lenovo logo, ThinkStation, ThinkShield, ThinkVision, and Vantage are trademarks or registered trademarks of Lenovo. Microsoft and Windows are registered trademarks of Microsoft Corporation. Intel, Xeon, Thunderbolt, and Intel vPro are trademarks of Intel Corporation or its subsidiaries in the U.S. and/or other countries. ENERGY STAR is a registered trademark of the U.S. Environmental Protection Agency. The NVIDIA logo, Quadro, and RTX are trademarks and/or registered trademarks of NVIDIA Corporation in the U.S. and other countries. Linux is the registered trademark of Linus Torvalds in the U.S. and other countries. Other company, product, and service names may be trademarks or service marks of others.

